

LANGDON

ALLOY

BY ONYX+EAST



2,094 sq. ft.



3 Bed



2.5 Bath



2-Car Attached

As you enter the Langdon, you'll enter the gathering room, open-concept kitchen, and dining nook. This kitchen is a chef's dream with Whirlpool® stainless steel appliances, quartz countertops, tiles backsplash and multiple design options that can be chosen from our design center. The owner's suite comes with a private bathroom, spacious walk-in closet through the bathroom. The remaining 2 bedrooms, a shared bath, and upstairs laundry room nicely complete the second floor. Personalizing your home is easy, we have plenty of choices for cabinets, countertops, hardware, backsplash, and even lighting will fit whatever your style may be.

Check Us Out!



SCAN ME



Coastal Elevation



Farmhouse Elevation



Low Country Elevation

LANGDON

3 Bed | 2.5 Bath | 2,094 sq. ft.

FIRST FLOOR

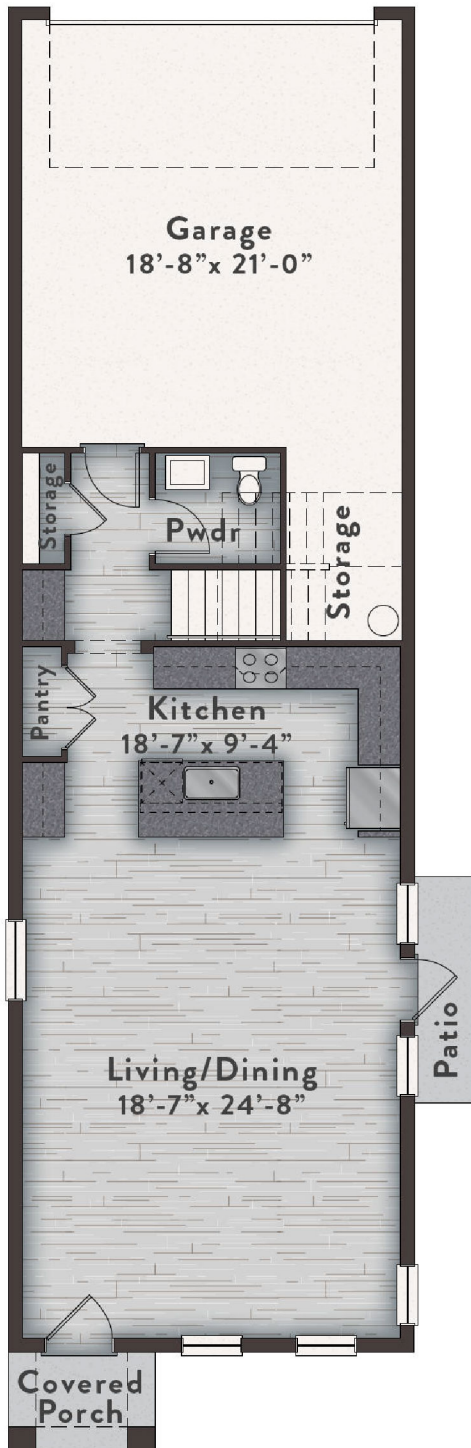

SECOND FLOOR

